



# YARD FORCE®

FOR LIFE ON THE GO

**LX JS12**  
**SHSD-01B**

GB

## JUMP START

Original Instructions

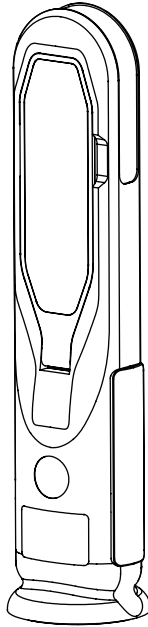

**READ & UNDERSTAND  
INSTRUCTION MANUAL**

**Save all warnings and instructions for future reference.**

# YARD FORCE

## LX JS12 Original Instruction

### TABLE OF CONTENTS

Intended use	4
General safety information	4
Product safety information	5
Symbols	8
Technical data	9
Description of product	10
Operation	11
Cleaning	16
Storage	16
Disposal	16
Troubleshooting	17
Declaration of Conformity	18



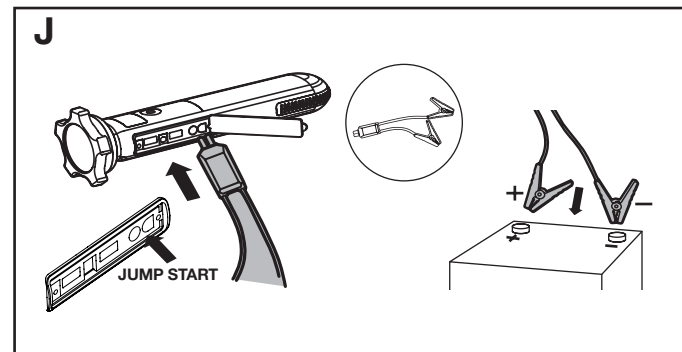
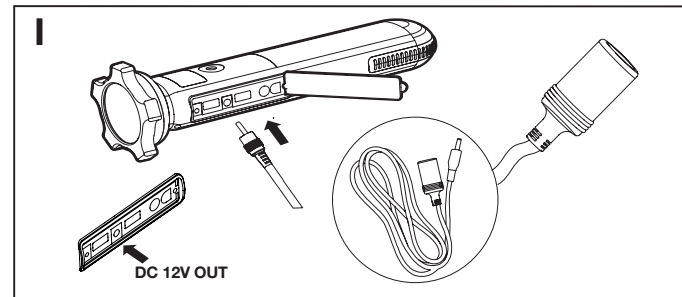
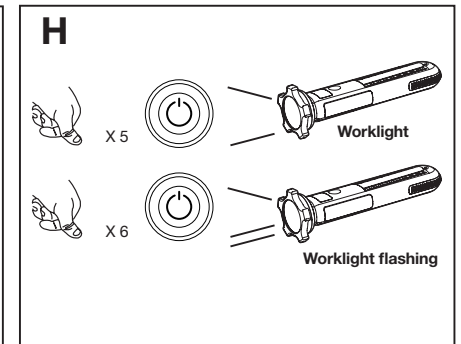
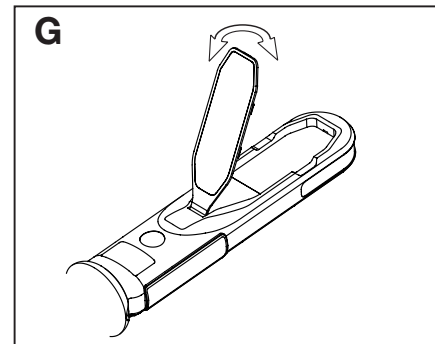
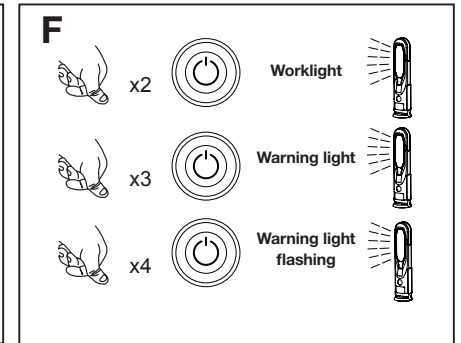
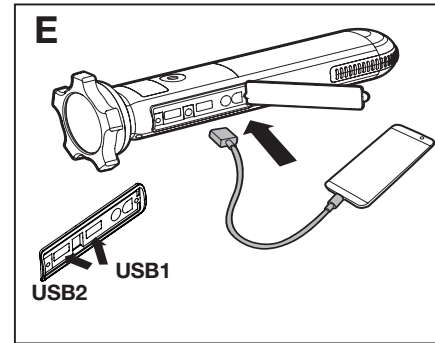
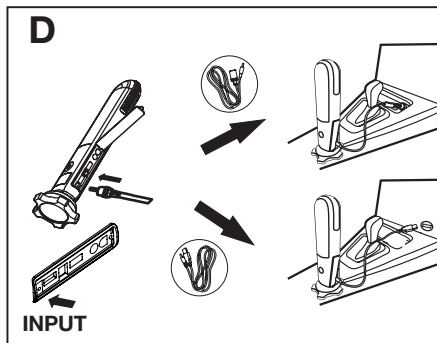
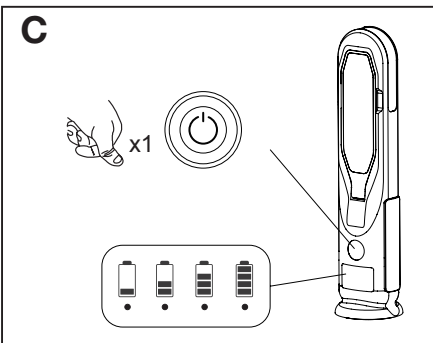
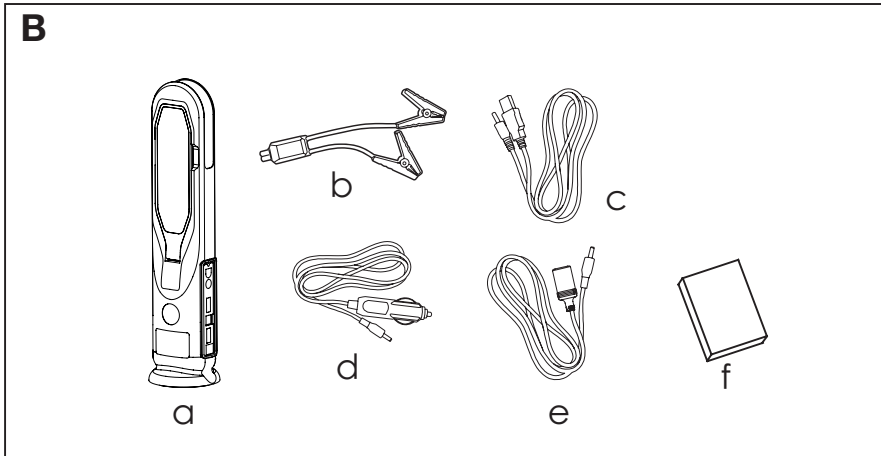
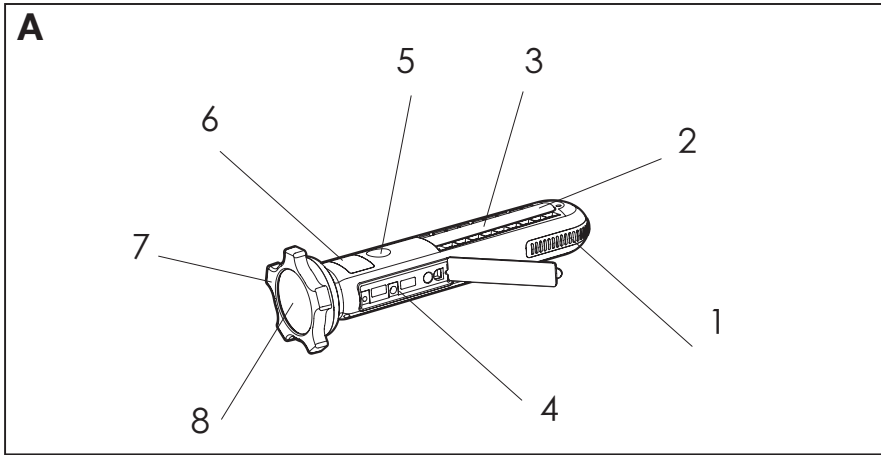

## INTENDED USE

This product is exclusively intended for the use as a mobile light beamer for limited time in dry indoor and outdoor areas as a helper in starting motor vehicles this flashlight has not been designed for use on vehicles according to the corresponding descriptions and safety instructions in these operating instructions Any other use is not as intended.

If the product is used for any purpose other than the intended purpose or if unauthorized modification is made, the statutory warranty and statutory responsibility for defects as well as any liability on the part of the manufacturer will be void.

Please keep in mind that our products are not designed for commercial, trade or industrial use according to their intended purpose. We accept no liability if the product is used in these or comparable conditions.

## GENERAL SAFETY INFORMATION



**WARNING: PLEASE READ THE OPERATING INSTRUCTIONS!** Read all instructions before operation. Pay special attention to safety instructions. **FAILURE TO FOLLOW THE INSTRUCTIONS AND FAILURE TO RESPECT SECURITY MEASURES MAY RESULT IN DAMAGE OF THE PRODUCT OR SERIOUS INJURIES.**

- The user is liable for all damages caused to third parties or their property.
- Keep these instructions manual and use them whenever you need more information. If you don't understand some of these instructions, contact your dealer. If the product is lent to another person, it is necessary to lent this instruction manual with it.

### Training

All operating personnel must be adequately trained in use, operation and setting and especially familiar with prohibited activities.

## PRODUCT SAFETY INFORMATION

- Never look into the LED beam. There is a risk of dazzling yourself and causing damage to the retina of the eye.
- Do not direct the light beam at persons or animals and do not stare into the light beam yourself (not even from a distance).
- Do not shock or disassemble the flashlight. Do not attempt to replace the LED bulbs!
- If the protective glass is cracked or broken, it must be replaced before the work light can be used again.
- Do not use flashlight in the rain, bad weather or in a moist environment.
- This flashlight has not been designed for use on vehicles and is not approved for illumination in road traffic.
- Keep handles dry, clean, free from oil and grease.
- The use of any accessory of attachment or performance of any operation with this tool other than those recommended in this instruction manual may present a risk of personal injury and/or damage to property.
- Use only spare parts and components, which the manufacturer delivers and recommends.
- Never put into water.
- If the device has been dropped or damaged by impact, fall, etc., always have it checked and if necessary, repaired by qualified service staff.
- Never disassemble the device.
- Never leave the device in a fully discharged state for a long time. The battery may be permanently damaged and the damage may be permanent. When not in use, recharge the device every three months.

## PRODUCT SAFETY INFORMATION

### Danger of Lithium batteries

Lithium batteries have high energy density and provide high performance in their application. Therefore, all safety instructions must be followed carefully when using, charging and storing lithium batteries. Due to their performance, all lithium batteries are potentially hazardous when damaged or used improperly, and may pose a serious RISK OF FIRE, for example, there is a risk during charging in these cases:

- Battery was fully discharged and was not recharged in a short time.
- Lithium batteries should be recharged within 24 hours after use, especially if they have been completely or nearly flat.
- Charging is performed at temperatures below 4 °C.
  - Charging below 4 °C causes a chemical reaction in the battery cells which can cause permanent damage, explosion or fire during charging
- Battery was in contact with liquid. (Salt water is especially risky.)
- Exposure to liquids can cause internal corrosion, cell damage or internal battery management system (BMS). BMS protects the battery from overcharging, deep discharge, or unbalanced cell charging. Therefore, a cell or BMS failure may present a risk of fire during charging
- Operating or charging a battery that has been damaged by dropping or shipping.
- If a crack or any mechanical damage occurs on the battery cover, the battery must not be used or charged.
- Use of a charger other than the original one (supplied with the device)
- Each battery charger charges specific voltage, current and has some other specific parameters to manage the charging of the battery. These parameters will vary significantly when using a different charger (for example, for different types of batteries - SLA, NiCd, NiMH, etc.).

## PRODUCT SAFETY INFORMATION

Therefore, never use any charger other than the one supplied with the device. Do not use for charging dry cells that are commonly used in household appliances. These batteries may break and cause personal injury and damage to property.

- NEVER LEAVE THE DEVICE ON DIRECT SUN OR IN PLACES WITH HIGH TEMPERATURE (temperature above 50 °C / e.g. behind car window in summer)!!!
- Temperature higher than the critical limit can result in overheating of lithium batteries, their explosion and subsequent flare-up. This warning applies generally to ALL devices in which lithium batteries are used.

### Service

- Do not attempt to repair the device yourself. Any work not listed in this manual MAY BE PERFORMED ONLY BY AUTHORIZED SERVICE CENTRES.
- Have your power tool serviced by a qualified repair person using only identical replacement parts. This will ensure that the safety of the power tool is maintained.

## SYMBOLS

### Safety symbols

The purpose of safety symbols is to attract your attention to possible dangers. The safety symbols and the explanations with them require your careful attention and full understanding. The symbol warnings do not, by themselves, eliminate any danger. The instructions and warnings they give are no substitutes for proper accident prevention measures.

 **WARNING:** Be sure to read and understand all safety instructions in this operator's manual, including all safety alert symbols such as **"DANGER,"** **"WARNING,"** and **"CAUTION"** before using this tool. Failure to follow all instructions listed below may result in electric shock, fire and/or serious personal injury.

**SAFETY ALERT SYMBOL:** Indicates **DANGER,** **WARNING,** or **CAUTION.** May be used in conjunction with other symbols or pictographs.

### Symbol meaning

This page depicts and describes safety symbols that may appear on this product. Read, understand and follow all instructions on the machine before attempting to assemble and operate.



To reduce the risk of injury, user must read the instruction manual carefully.



Do not store or use the battery in locations where the temperature may reach or exceed 50 °C.



Always wear safety glasses when working with batteries. Use eye protection.

## SYMBOLS



Always wear safety gloves when operation.



Due to their performance, all lithium batteries are potentially hazardous when damaged or used improperly, and may pose a serious RISK OF FIRE.



Do not discard electrical appliances with household waste.



Product conforms to relevant EU standards.







Batteries contain Li-ion. Do not dispose of waste batteries in domestic waste. Contact local authority to find out how to dispose of batteries.



A product placed on the United Kingdom market meets the UKCA Marking requirements

## TECHNICAL DATA

Model	LX JS12
Degree of protection	IP54
Battery capacity	3x4000mAh, 11.1V DC Lithium 41.07Wh
Output (USB1, USB2)	5 V  , max 2.1 A
Output 12V OUT	12 V  , max 8 A
Jump start connection (JUMP START)	500 A, only for use with the "SMART JUMPER" jump start cable
INPUT (USB type A)	5 V  , 2 A
INPUT (Car cigarette lighter)	12 V  , 2 A
Fuse (Car cigarette lighter)	F2AL250V 
Weight	0.48 kg

## DESCRIPTION OF PRODUCT

### Parts description (Fig. A)

1. Hanging loop
2. LED working light
3. Red emergency warning light
4. Connectors
5. On/Off switch
6. Battery status indication
7. Magnet for mounting
8. Flash light& SOS signal light

### Delivery contents (Fig. B)

Carefully unpack the appliance and check that it is complete. Dispose of the packaging material correctly.

- a. Jump start
- b. Jump start cable
- c. Charging cable (USB type)
- d. Charging cable (Car cigarette lighter)
- e. 12V output cable (Car cigarette lighter adaptor)
- f. Instruction manual

## OPERATION

### Charging the device

The supplied battery is only partially charged. Before initial use, fully charge battery.

After the first charge, we recommend fully discharging the battery and the full charge/ discharge process to be repeated once or twice to "format" the battery pack. Perform this charge as soon as possible after the battery has been discharged and cooled.

To ensure long life of the battery, it must be maintained carefully

- The battery must be recharged
  - before using the machine for the first time after purchase
  - often, during use/season, usually after using the machine
  - before leaving the machine disused for a long period;
  - during long-term storage
  - before starting up the machine after a long period of disuse
- The discharged battery must be recharged as soon as possible. Let a hot battery cartridge cool down before charging it
- Recharge the accumulators in time, before they are discharged fully, otherwise the accumulators can be damaged permanently (irreversibly). It is ideal to recharge the battery after each consumption
- The lithium-ion battery can be charged in any state of charge, and the charging process can be interrupted at any time without harming the battery (no memory effect)
- An unused battery loses capacity faster than a battery which is being used.
- Charge the battery pack in a dry place with room temperature at 5 °C–40 °C.
- It is possible that the battery and/or charger can become moderately warmer during charging, this is normal and doesn't indicate a fault
- Never cover the charger.
- Significantly reduced machine operating times and accelerated battery charging times indicate that the battery has a reduced capacity and should be replaced.



**Caution!** Never charge the battery in an explosive or flammable environment and near flammable liquids. Don't carry out charging on a slightly flammable substrate (such as paper, textiles, etc.) when the battery is removed. Never charge a battery which is visibly damaged or its filling is leaking.

## OPERATION

The charger was designed to charge battery pack between 0 °C and 50 °C. If the battery pack is too cold or too hot, the charger will not charge. Allow the battery to warm up or cool down.

### Battery status indicators

When charging for the first time, the device should be charged for at least 6 hours.

### Charging status indicator

Press the power button once (Fig. C) - front - to see the battery status. The battery status is indicated by four blue LEDs below the power button as follows:

- One LED = flat = do not use and recharge immediately
- Two LEDs = 25-50% capacity = recharge as soon as possible
- Three LEDs = 50-75% capacity = charge if to be used as starting aid
- Four LEDs = 75-100% capacity = fully or almost fully charged

We recommend having the battery fully charged if the device is to be used as a starting aid. This will significantly increase your chances of success.

### Charging the device(Fig. D)



**WARNING!** Never use anything other than the original charger to charge.

1. Connect the power connector at the end of the charger cable to the DC IN socket.
2. Connect the power supply plug to the mains electricity outlet or the charging adapter for the cigarette lighter socket.
3. The charger can remain plugged in for a limited time after recharging without the undesirable effect of overcharging the battery. However, when the battery is fully charged, disconnect it.

**NOTE:** The blue status lights will gradually turn on according to the charging status and progress. If all four blue LEDs are on, the battery is fully charged.

**NOTE:** The charging time is affected by discharge level and battery capacity. Charging a depleted battery can last up to 10 hours.

## OPERATION

### Use as a usb power source(Fig. D)

This device can be used to power or recharge a wide range of small electronic devices.

1. Connect the device's charging cable to the electronic device.
2. Connect the USB connector of the charging cable to the USB port on the device.
3. Press the power button to activate USB charging.

### Use as a work light(Fig. F)

This device has several different work light modes.

1. Pressing the power button for the first time turns the unit on, activates the USB ports, and the battery status panel.
2. The second pressing turns on the primary work light.
3. The third pressing turns on the red light.
4. The fourth pressing turns on the intermittent red light.  
**Note:** work light panel can be pulled out as Fig G shown.
5. The fifth pressing lights up the front, focusing lights.(Fig. H)
6. The sixth pressing turns on the SOS signal light.(Fig. H)
7. The seventh pressing turns off the entire device.

**NOTE:** In any of the above work light modes, you can turn off the device by press and holding the power button for four seconds. The battery status panel appears.

### Use as a 12V power source

use the 12V output cable(Car cigarette lighter adaptor) connected to the device as a 12V power source.

### Use as a starting aid(Fig. J)



**CAUTION!** Always use this device for this function only with the supplied SMART Cable. NEVER use other cables and alternative solutions!

To achieve optimum performance, do not store this device at temperatures below 10°C before using as the starting aid. Never charge or start a vehicle with a frozen car battery.

1. Read these operating instructions and the operating manual/safety manual provided by the vehicle manufacturer.
2. Use the starting aid only in a well-ventilated area.
3. Always wear safety glasses when working with batteries. Use eye protection.



## OPERATION

4. Connect the SMART Cable connector to the device. The connector is under the cover on the side of the device. Make sure the cable is securely connected after connecting. The Smart Cable will beep several times and all LEDs will flash (status check). Then the blue LED starts flashing to indicate that the device is in standby mode.
5. Switch off the ignition completely before connecting the device to the vehicle.
6. Connect the positive (red +) collet to the positive clamp of the car battery (or the positive connection point as recommended by the vehicle manufacturer).
7. Connect the negative (black-) collet to the negative clamp of the car battery, to the vehicle frame (ground) or other negative connection point, as recommended by the vehicle manufacturer.



**CAUTION!** Make sure the connecting cable is not within range of moving engine parts (belts, fan, alternator, etc.). Both the device and the SMART Cable must be placed on a non flammable surface.

8. When connected, the SMART Cable evaluates the connection.
  - a) If the light on the SMART Cable turns green, the battery is within the normal voltage range. You have 30 seconds to start the vehicle after connecting. Then the device returns to standby mode.
  - b) If the light on the SMART Cable turns red and a warning buzzer sounds, it indicates a reverse battery connection. Disconnect the vehicle cables immediately and connect them correctly!
  - c) If the connection is made correctly, but the red LED still lights up on the SMART Cable and the cable beeps, the car battery is discharged below 10V. You can get around this warning by pressing the Override button on the SMART Cable side for 4 seconds. The green LED lights up. You have 30 seconds to start the vehicle. Then the device returns to standby mode.
9. Nobody should be within range of the battery while starting the vehicle.
10. Try to start the vehicle (turn the key).



**CAUTION!** If the vehicle fails to start within 6 seconds, do not attempt to start it again immediately, allow the device to cool for 3 minutes. Try again only after the 3 minutes.

## OPERATION

**NOTE:** The device may not be able to help you in the first attempt to start the vehicle in very cold weather. We recommend repeating. You have a better chance of starting in the second and third attempt because the device warms up the car battery and increases your chances of starting. However; do not try to start the vehicle after an unsuccessful fourth attempt the device will no longer have enough power.

11. When the vehicle is started, the blue LED lights up on the SMART Cable and the warning signal beeps briefly.
12. Disconnect the negative (black) collet (-).
13. Disconnect the positive (red) collet (+).
14. Disconnect the SMART Cable from the device and store for future use.

## CLEANING



**Caution!** Protect the product from direct contact with water, and make sure that water doesn't get the opportunity to get in.

- Always clean the product thoroughly after each use with a damp cloth, sponge or brush.
- Avoid oil and grease contamination (especially to gripping parts). If contamination should occur, wipe the product with a damp cloth moistened with soapy water.
- Never use aggressive cleaning agents, solvents or chemicals for cleaning. Permanent damage to plastic parts could occur.

## STORAGE

- Store the machine out of reach of children.
- Don't store the product in direct sunlight for long periods.
- For safety reasons worn or damaged parts should be replaced.
- Store in the original packaging (if possible) in a clean, dry, dark and frost-free place protected from dust and out of reach of children.
- Cover unit with a suitable protective cover that does not retain moisture. Do not use sheet plastic as a dust cover. A nonporous cover will trap moisture around the machine, promoting rust and corrosion.
- The ideal storage temperature is between 5 and 30 °C.

## DISPOSAL

- Dispose your device, accessories and packaging in accordance with the requirements of environmental protection into the recycling collection center.
- This machine does not belong to the household waste. Save the environment and take this device to designated collection points where it will be received for free. For more information please contact your local authority or nearest collection point. Improper disposal may be punished according to national regulations.
- The battery contains toxic substances. Toxic materials must be disposed of in a specified manner in order to prevent contamination of the environment. Take used batteries to a recycling center. Do not throw the battery into household waste, fire or water.

## TROUBLESHOOTING

Problem	Failure
The device was recharged, the charging LED signalled but there was no change in status even after several hours.	Defective charger
The four blue status LEDs are lit during charging, indicating that the battery is fully charged. However, when the unit is removed from the charger and the power button is pressed, the status LEDs indicate a low or flat battery.	Defective battery

## DECLARATION OF CONFORMITY

To the provisions of Council Directives

We  
**MEROTEC GmbH,**  
**Otto-Brenner-Straße 8,**  
**47877 Willich/ Deutschland**

Declare that the product:  
Description: Jump start  
Model No. LX JS12 / SHSD-01B  
Function: jump start, work light, power bank

### Complies with the essential health and safety requirements of the following directives:

Electromagnetic Compatibility Directive 2014/30/EU  
EC Directive 2011/65/EU and its amendment Directive (EU) 2015/863 (RoHS)

### Standards and technical specification referred to:

EN IEC 55015:2019+A11:2020  
EN 61547:2009  
EN 62471:2008

Authorized Signatory  
Date: 18.01.2021

Signature: *Roland Menken*  
Place: Willich  
Name: Roland Menken  
General Manager



MEROTEC GmbH,  
Otto-Brenner-Straße 8,  
47877 Willich/ Deutschland

## DECLARATION OF CONFORMITY

To the provisions of Council Directives

We  
**SUMEC UK**  
**Unit A&B Escrick Business Park Escrick, York YO19 6FD**  
**United Kingdom**

Declare that the product:  
Description: Jump start  
Model No. LX JS12 / SHSD-01B  
Function: jump start, work light, power bank

### Complies with the essential health and safety requirements of the following directives:

Electromagnetic Compatibility Regulations 2016  
The Restriction of the Use of Certain Hazardous Substances in Electrical and Electronic Equipment Regulations 2012

### Standards and technical specification referred to:

EN IEC 55015:2019+A11:2020  
EN 61547:2009  
EN 62471:2008

Authorized Signatory  
Date: 18.01.2021

Signature: *M. Hall*  
Place: York  
Name: Mariana Hall  
General Manager

SUMEC UK Co.,Ltd.  
Unit A&B Escrick Business Park  
Escrick, York YO19 6FD  
United Kingdom



# DECLARATION OF CONFORMITY

To the provisions of Council Directives

We  
**SUMEC France Sarl**  
59 bis Rue du Mûrier  
37540 Saint Cyr Sur Loire, France

Declare that the product:  
Description: Jump start  
Model No. LX JS12 / SHSD-01B  
Function: jump start, work light, power bank

**Complies with the essential health and safety requirements of the following directives:**

Electromagnetic Compatibility Directive 2014/30/EU  
EC Directive 2011/65/EU and its amendment Directive (EU) 2015/863 (RoHS)

**Standards and technical specification referred to:**

EN IEC 55015:2019+A11:2020  
EN 61547:2009  
EN 62471:2008

Authorized Signatory  
Date: 18.01.2021

Signature: \_\_\_\_\_



Place: Saint Cyr Sur Loire  
Name: Rodolphe Dubois  
General Manager

SUMEC France Sarl  
59 bis Rue du Mûrier  
37540 Saint Cyr Sur Loire, France

